



LIGHT OIL

### Light oil burner. Operation:

Low NOx and CO emissions light oil burner according to European standard EN267:

Adjusting the combustion head.

Maintenance facilitated by the possibility of removing the combustion head without having to remove the burner from the boiler.

Fixed boiler coupling flange.

Sliding boiler coupling flange to adapt the blast-pipe to the various types of boilers.

Combustion air intake with butterfly valve. Air flow adjustment:

Fully closing air damper on shutdown to avoid loss of heat through the chimney.

Fuel supply circuit made of gear pump with pressure adjustment and shut-off valves.

Light oil preheater with variable capacity.

Flame detection by photoresistance.

Electric protection rating:

Sound-proof plastic protective cover.

	BTL 3	BTL 3 H	RINOx 35 L
	single-stage	single-stage	single-stage
Low NOx and CO emissions light oil burner according to European standard EN267:			class 3
Adjusting the combustion head.	•	•	•
Maintenance facilitated by the possibility of removing the combustion head without having to remove the burner from the boiler.	•	•	•
Fixed boiler coupling flange.	•	•	
Sliding boiler coupling flange to adapt the blast-pipe to the various types of boilers.			•
Combustion air intake with butterfly valve. Air flow adjustment:	manual	manual	manual
Fully closing air damper on shutdown to avoid loss of heat through the chimney.	•	•	•
Fuel supply circuit made of gear pump with pressure adjustment and shut-off valves.	•	•	•
Light oil preheater with variable capacity.		•	•
Flame detection by photoresistance.	•	•	•
Electric protection rating:	IP40	IP40	IP40
Sound-proof plastic protective cover.	•	•	•

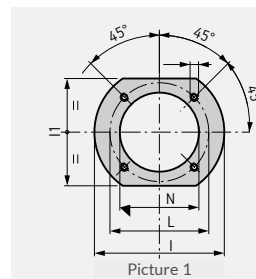
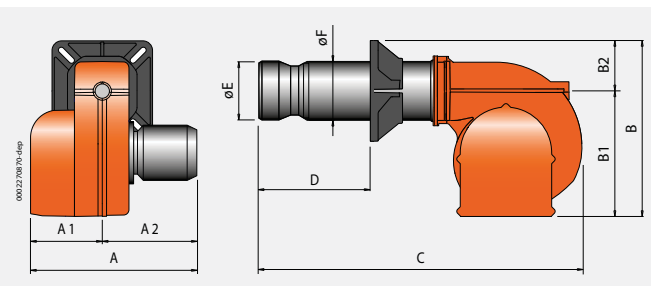

Flange dimensions and boiler drilling template.

Model	A mm	A1 mm	A2 mm	B mm	B1 mm	B2 mm	C mm	D mm	E mm	F mm	I mm	I1 mm	L mm	M mm	N mm	Pic.
BTL 3	250	120	130	242	170	72	330	90	80	80	170	144	135 ÷ 161	M8	85	1
BTL 3 H	250	120	130	242	170	72	330	90	80	80	170	144	135 ÷ 161	M8	85	1
RINOx 35 L	246	123	123	289	219	70	410	50 ÷ 105	80	80	170	140	130 ÷ 155	M8	85	1

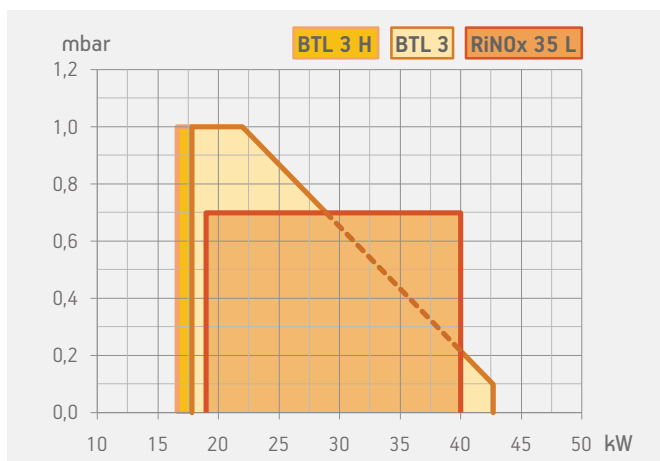

Model	Size of packaging			Weight kg
	L	P mm	H	
BTL 3	400	300	280	9
BTL 3 H	400	300	280	9
RiNOx 35 L	540	300	320	12

	Emissions class	Thermal output kW	Model	Part no.	Max visc. °E at 20°C	Electrical supply	Motor kW	Notes
Frequency 50 Hz								
	class 3	17,8 ÷ 42,7	<b>BTL 3</b>	<b>35450010</b>	1,5	1N AC 50Hz 230V	0,09	1)
		16,6 ÷ 42,7	<b>BTL 3 H</b>	<b>35450011</b>	1,5	1N AC 50Hz 230V	0,09	1) 2)
		19,0 ÷ 40,0	<b>RiNOx 35 L</b>	<b>35470050</b>	1,5	1N AC 50Hz 230V	0,10	1) 2)
Frequency 60 Hz								
		17,8 ÷ 42,7	<b>BTL 3</b>	<b>35450010</b>	1,5	1N AC 60Hz 220V	0,09	1)
		16,6 ÷ 42,7	<b>BTL 3 H</b>	<b>35450011</b>	1,5	1N AC 60Hz 220V	0,09	1) 2)

### OPTIONALS

#### DESCRIPTION

BTL 3/3 H: 200 mm long combustion head

Biodiesel operation (5)

### LIGHT OIL BURNER ACCESSORIES

Line filter, flex hoses, nozzle, boiler coupling kit, plug for wiring.

### NOTES

- 1 Equipped with air closure device.
- 2 Equipped with light oil pre-heater with drop-stop device.
- 5 Biodiesel according to european norm EN14213-FAME.  
Net calorific value of light oil: Hi = 42,70 MJ/kg = 10200 kcal/kg.